

May 19, 2010



Product Safety Alert

Schneider Electric Recalls Stab-lok Circuit Breakers Type NA15 / NA20 / NB15 / NB20

Toronto, ON – The Electrical Safety Authority is notifying the public that Schneider Electric Canada has announced a voluntary recall of the following industrial/commercial products:

Power supply units for certain Zebra brand thermal printers.

Users should stop using recalled products immediately.

Name of Product: Stab-lok NA15, NA20, NB15 and NB20

Units: 330 units sold across Canada.

Manufacturer: Schneider Electric Canada

Hazard: A small number of circuit breaker handles were moulded with the ON and OFF impressions interchanged. There is the possibility for the circuit breaker handle to indicate the OFF (open) position when the circuit breaker is still in an ON (closed) position. This may result in the potential for PERSONAL INJURY.

Incidents/Injuries: No injuries or damages have been reported.

Description/Models: Stab-lok circuit breaker models NA15, NA20, NB15 and NB20 with a date code of 1002 to 1014 only. The date code is stamped on the product label located next to the handle. The date code is also stamped on the product carton.

Sold by: Schneider Electric Canada distributors

When was distributed: Between January 12, 2010 and April 7, 2010

Manufactured in: Mexico

Remedy: Immediately inspect the Circuit Breakers for the correct handle, as show in the photos below. If a product with the incorrect handle is found, contact the Schneider Electric Product Recovery number below to arrange for free installation of replacement product. Circuit breakers should be replaced by a licensed electrician only.

May 19, 2010

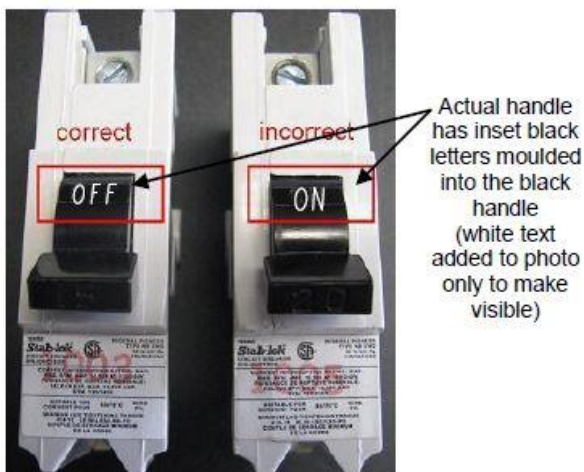

Figure 1

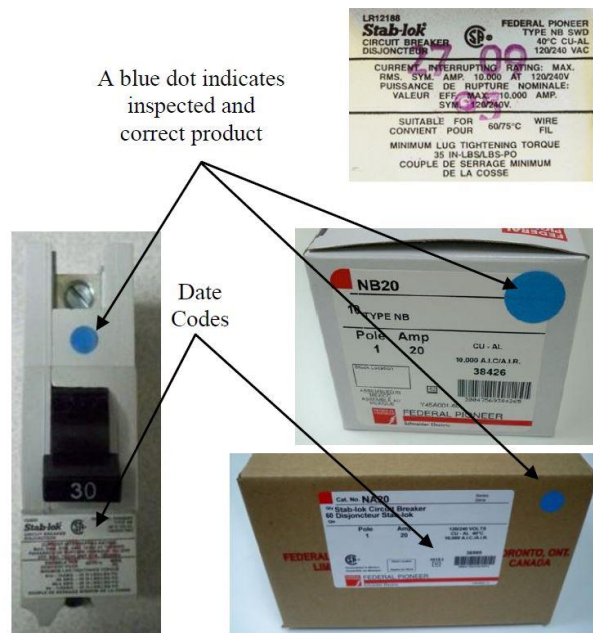

Figure 2

Contact: Schneider Electric
 Product Recovery Administration
 Phone: 1-866-333-1490
 Fax: 1-866-587-4070

Remarks: Although the circuit breaker mechanism is completely functional and will correctly trip on both overload and short circuit; however, there is still a potential for personal injury, if the circuit breaker handle indicated OFF when the circuit breaker is ON. Users with the affected product should contact Schneider Electric immediately.

Products and cartons marked with blue dots (shown below) have been inspected and found to have proper markings. Products and products in cartons with blue dots are approved for sale.

The recalled units are certified to Canadian Standards by Canadian Standards Association (CSA). For more information about CSA product certification process please visit: www.csa-international.org.